

REVISIONS
NO. 1
DATE

REVISIONS
NO. 2
DATE

REVISIONS
NO. 3
DATE




BENCH MARK
Screw NE Corner Mt. Vernon Ave.
Sixteenth St. Elev. 1173.03 N.T.L.

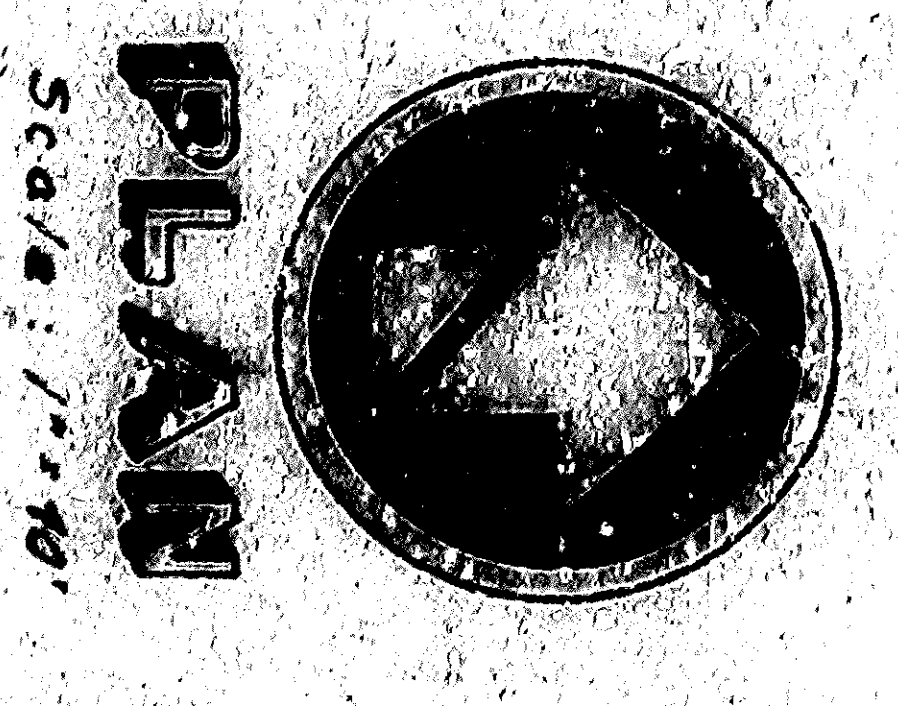

APPROVED	DATE: APRIL 12, 1928
DRAWN BY	NO. 1
CHECKED BY	DATE
RECOMMENDED	DATE
CITY OF SAN BERNARDINO DEPARTMENT OF ENGINEERING SIXTEENTH STREET MT. VERNON AVENUE TO FREEWAY	

REVISIONS
 1. 11/20/28
 2. 1/13/29

REVISIONS
 3. 1/13/29
 4. 1/13/29

REVISIONS
 5. 1/13/29
 6. 1/13/29

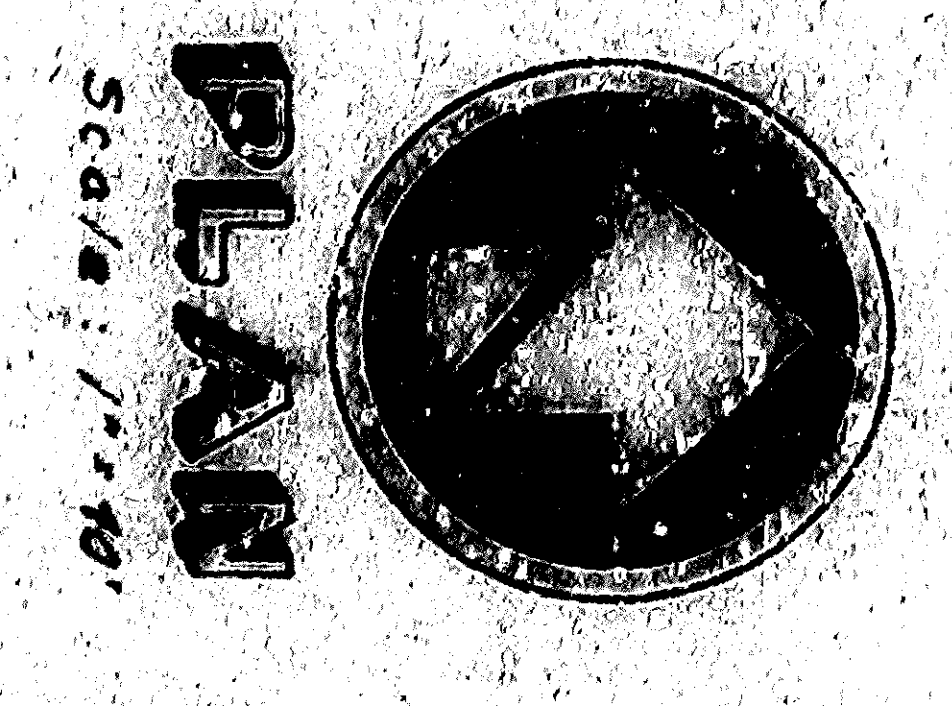



APPROVED	DATE: APRIL 12, 1928
DESIGNED BY: [Signature]	
CHECKED BY: [Signature]	
RECOMMENDED BY: [Signature]	
SHEET 3 OF 6 SHEETS	
CITY OF SAN BERNARDINO DEPARTMENT OF ENGINEERING CURB, GUTTER & PAVING SIXTEENTH STREET MT. VERNON AVENUE TO FREEWAY	